

# EXPERTIG 9

CE EN60974-7



| CODE            | ↔   |       |               |             |
|-----------------|-----|-------|---------------|-------------|
| TA0904S-511-WA3 | 4 m | 12,5' | Single Button | TSK 50-1/4G |
| TA0908S-511-WA3 | 8 m | 25'   |               |             |

### OPTIONAL STARTER KIT

| CODE   | ∅      |       |     |   |
|--------|--------|-------|-----|---|
| TT0101 | 1,6 mm | 1/16" | WR2 | 1 |
| TT0102 | 2,4 mm | 3/32" | WR2 | 1 |

| TECHNICAL DATA |                   |                |
|----------------|-------------------|----------------|
|                | <b>EXPERTIG 9</b> |                |
|                | 0,45 kg           | 0,99 lb        |
|                | 113               |                |
|                | Argon             |                |
|                | 0,5 ÷ 2,4 mm      | 0,020" ÷ 3/32" |
|                | 110A DC - 95A AC  |                |

|    | CODE       |  | Description                  |    |
|----|------------|--|------------------------------|----|
| 4  | TQ0001     |  | insulator                    | 10 |
| 5  | TF0009     |  | tig 9 torch head             | 1  |
| 6  | TF0010     |  | tig 9 flex torch head        | 1  |
| 7  | BW0063     |  | back cap 147,5 mm            | 10 |
| 7  | EA0129     |  | O-ring ∅ 4,5x2 mm            | 10 |
| 8  | TT0611     |  | 1 button kit                 | 1  |
| 9  | TT0630     |  | pc-board                     | 1  |
| 10 | BW0310     |  | cable joint                  | 1  |
| 10 | TT0601     |  | handle kit                   | 1  |
| 11 | TH1471-040 |  | cable assembly - 4 m / 12.5' | 1  |
| 11 | TH1471-080 |  | cable assembly - 8 m / 25'   | 1  |
| 12 | TH0005     |  | power cable - 4 m / 12.5'    | 1  |
| 12 | TH0006     |  | power cable - 8 m / 25'      | 1  |
| 13 | CX0077     |  | TSK 50 - 1/4 G plug          | 1  |

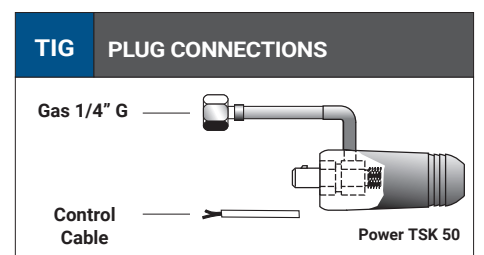
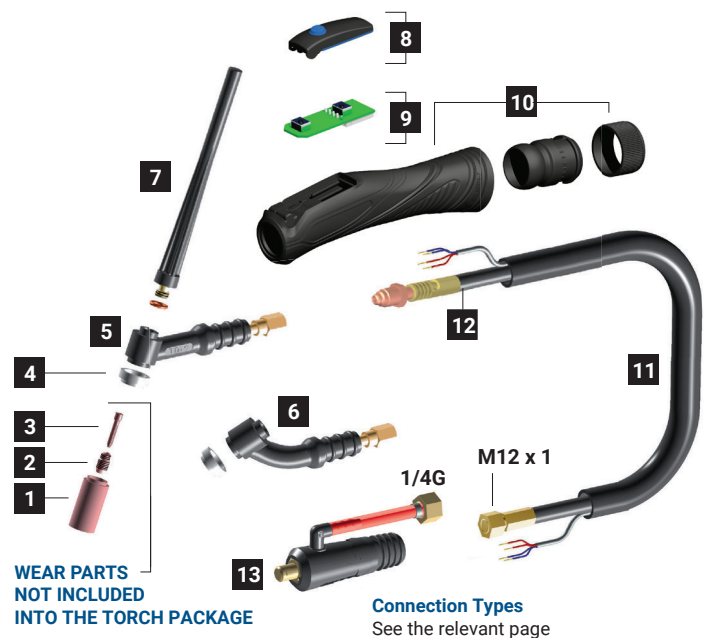

# TIG 9 / 20 / 20 HC / 25 - CONSUMABLES

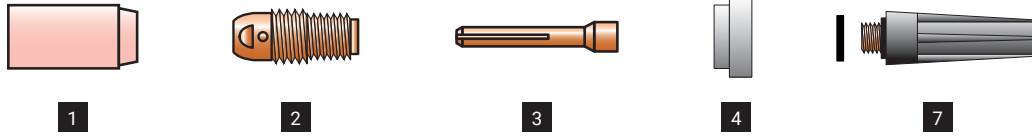

## STANDARD

|   | CODE      |   | Gr          | Ø             |        | REF    |    |
|---|-----------|---|-------------|---------------|--------|--------|----|
| 1 | TC0012    |   | 4           | 6,4 mm 1/4"   | 30 mm  | 13N08  | 10 |
| 1 | TC0013    |   | 5           | 8 mm 5/16"    | 30 mm  | 13N09  | 10 |
| 1 | TC0014    |   | 6           | 9,8 mm 3/8"   | 30 mm  | 13N10  | 10 |
| 1 | TC0015    |   | 7           | 11,2 mm 7/16" | 30 mm  | 13N11  | 10 |
| 1 | TC0016    |   | 8           | 12,7 mm 1/2"  | 30 mm  | 13N12  | 10 |
| 1 | TC0017    |   | 10          | 15,7 mm 5/8"  | 30 mm  | 13N13  | 10 |
| 1 | TC0096    |   | 4           | 6,5 mm 1/4"   | 48 mm  | 796F71 | 10 |
| 1 | TC0097    |   | 5           | 8 mm 5/16"    | 48 mm  | 796F72 | 10 |
| 1 | TC0098    |   | 6           | 9,5 mm 3/8"   | 48 mm  | 796F73 | 10 |
| 1 | TC0101    |   | 4           | 6,5 mm 1/4"   | 63 mm  | 796F75 | 10 |
| 1 | TC0102    | 5 | 8 mm 5/16"  | 63 mm         | 796F76 | 10     |    |
| 1 | TC0103    | 4 | 6,5 mm 1/4" | 89 mm         | 796F79 | 10     |    |
| 2 | TE0003-05 |   |             | 0,5 mm .020"  | 21 mm  | 13N25  | 10 |
| 2 | TE0003-10 |   |             | 1,0 mm .040"  | 21 mm  | 13N26  | 10 |
| 2 | TE0003-16 |   |             | 1,6 mm 1/16"  | 21 mm  | 13N27  | 10 |
| 2 | TE0003-20 |   |             | 2,0 mm 5/64"  | 21 mm  | -      | 10 |
| 2 | TE0003-24 |   |             | 2,4 mm 3/32"  | 21 mm  | 13N28  | 10 |
| 2 | TE0003-32 |   |             | 3,2 mm 1/8"   | 21 mm  | 13N29  | 10 |

|   | CODE      |  | Gr | Ø            |          | REF    |    |
|---|-----------|--|----|--------------|----------|--------|----|
| 3 | TD0003-05 |  |    | 0,5 mm .020" | 25 mm    | 13N20  | 10 |
| 3 | TD0003-10 |  |    | 1,0 mm .040" | 25 mm    | 13N21  | 10 |
| 3 | TD0003-16 |  |    | 1,6 mm 1/16" | 25 mm    | 13N22  | 10 |
| 3 | TD0003-20 |  |    | 2,0 mm 5/64" | 25 mm    | -      | 10 |
| 3 | TD0003-24 |  |    | 2,4 mm 3/32" | 25 mm    | 13N23  | 10 |
| 3 | TD0003-32 |  |    | 3,2 mm 1/8"  | 25 mm    | 13N24  | 10 |
| 4 | TQ0001    |  |    |              |          | 598882 | 10 |
| 7 | BW0063    |  |    |              | 147,5 mm | 41V24  | 10 |
| 7 | BW0064    |  |    |              | 53 mm    | 41V35  | 10 |
| 7 | BW0065    |  |    |              | 17,5 mm  | 41V33  | 10 |
| 7 | EA0129    |  |    |              |          |        | 10 |

## GAS LENS

|   | CODE      |  | Gr | Ø             |              | REF    |       |
|---|-----------|--|----|---------------|--------------|--------|-------|
| 1 | TC0041    |  | 4  | 6,4 mm 1/4"   | 25,5 mm      | 53N58  | 10    |
| 1 | TC0042    |  | 5  | 8 mm 5/16"    | 25,5 mm      | 53N59  | 10    |
| 1 | TC0043    |  | 6  | 9,8 mm 3/8"   | 25,5 mm      | 53N60  | 10    |
| 1 | TC0044    |  | 7  | 11,2 mm 7/16" | 25,5 mm      | 53N61  | 10    |
| 1 | TC0045    |  | 8  | 12,7 mm 1/2"  | 25,5 mm      | 53N61S | 10    |
| 2 | TE0005-05 |  |    | 0,5 mm .020"  | 22 mm        | 45V41  | 10    |
| 2 | TE0005-10 |  |    | 1,0 mm .040"  | 22 mm        | 45V42  | 10    |
| 2 | TE0005-16 |  |    | 1,6 mm 1/16"  | 22 mm        | 45V43  | 10    |
| 2 | TE0005-20 |  |    | 2,0 mm 5/64"  | 22 mm        | -      | 10    |
| 2 | TE0005-24 |  |    | 2,4 mm 3/32"  | 22 mm        | 45V44  | 10    |
| 2 | TE0005-32 |  |    | 3,2 mm 1/8"   | 22 mm        | 45V45  | 10    |
| 2 | TE0025-16 |  |    | 1,6 mm 1/16"  | 22 mm        | -      | 10    |
| 2 | TE0025-20 |  |    | 2,0 mm 5/64"  | 22 mm        | -      | 10    |
| 2 | TE0025-24 |  |    | 2,4 mm 3/32"  | 22 mm        | -      | 10    |
| 2 | TE0025-32 |  |    | 3,2 mm 1/8"   | 22 mm        | -      | 10    |
| 3 | TD0003-05 |  |    |               | 0,5 mm .020" | 25 mm  | 13N20 |
| 3 | TD0003-10 |  |    | 1,0 mm .040"  | 25 mm        | 13N21  | 10    |
| 3 | TD0003-16 |  |    | 1,6 mm 1/16"  | 25 mm        | 13N22  | 10    |
| 3 | TD0003-20 |  |    | 2,0 mm 5/64"  | 25 mm        | -      | 10    |
| 3 | TD0003-24 |  |    | 2,4 mm 3/32"  | 25 mm        | 13N23  | 10    |
| 3 | TD0003-32 |  |    | 3,2 mm 1/8"   | 25 mm        | 13N24  | 10    |
| 4 | TQ0001    |  |    |               |              | 598882 | 10    |
| 7 | BW0063    |  |    |               | 147,5 mm     | 41V24  | 10    |
| 7 | BW0064    |  |    |               | 53 mm        | 41V35  | 10    |
| 7 | BW0065    |  |    |               | 17,5 mm      | 41V33  | 10    |
| 7 | EA0129    |  |    |               |              |        | 10    |

## GAS LENS XL (JUMBO)

|   | CODE      |  | Gr          | Ø            |          | REF     |    |
|---|-----------|--|-------------|--------------|----------|---------|----|
| 1 | TC0118    |  | 8           | 12,7 mm 1/2" | 48 mm    | 57N74   | 10 |
| 1 | TC0119    |  | 10          | 15,7 mm 5/8" | 48 mm    | 53N88   | 10 |
| 1 | TC0120    |  | 12          | 19,5 mm 3/4" | 48 mm    | 53N87   | 10 |
| 2 | TE0088-16 |  |             | 1,6 mm 1/16" | 40 mm    | 45V116S | 2  |
| 2 | TE0088-24 |  |             | 2,4 mm 3/32" | 40 mm    | 45V64S  | 2  |
| 2 | TE0088-32 |  | 3,2 mm 1/8" | 40 mm        | -        | 2       |    |
| 3 | TD0088-16 |  |             | 1,6 mm 1/16" | 40 mm    | 13N22L  | 10 |
| 3 | TD0088-20 |  |             | 2,0 mm 5/64" | 40 mm    | -       | 10 |
| 3 | TD0088-24 |  |             | 2,4 mm 3/32" | 40 mm    | 13N23L  | 10 |
| 3 | TD0088-32 |  |             | 3,2 mm 1/8"  | 40 mm    | 13N24L  | 10 |
| 4 | TQ0026    |  |             |              |          | 54N6320 | 10 |
| 7 | BW0063    |  |             |              | 147,5 mm | 41V24   | 10 |
| 7 | BW0064    |  |             |              | 53 mm    | 41V35   | 10 |
| 7 | BW0065    |  |             |              | 17,5 mm  | 41V33   | 10 |
| 7 | EA0129    |  |             |              |          |         | 10 |

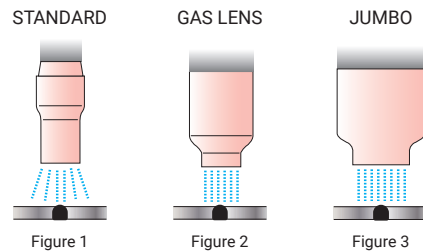

Protection gas flow is usually guttered by a STANDARD ceramic nozzle (Figure 1). Such flow is affected by turbulences of torch head which are caused by the inlet pressure. In order to assure an uniform gas distribution, above all in stainless steel, titanium and aluminium alloys welding, we suggest the use of GAS LENS spare parts. The electrode holder equipped with a gas lens net, uniformes the flow (Figure 2) and aid to save the protection gas. Where permitted by external dimensions, it is recommended the JUMBO version which increases the protected surface with advantage for welding quality (Figure 3).